

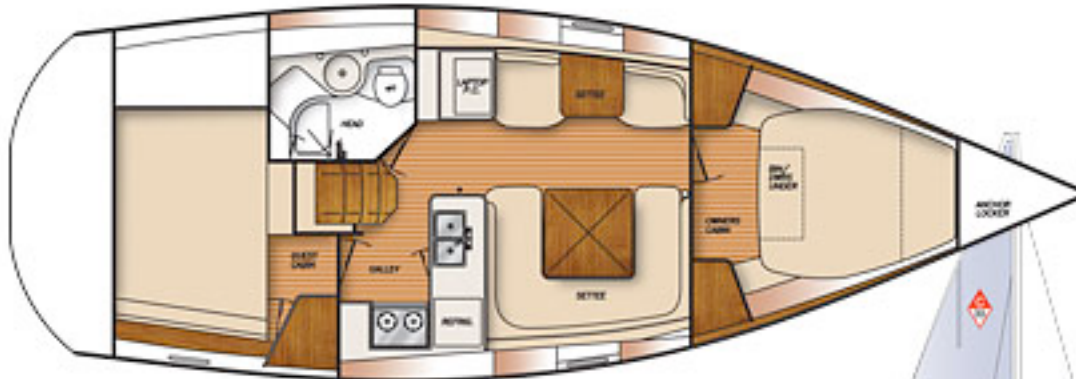

Catalina



CATALINA 355 Principal Specifications

Length Overall	10.76 m	35' - 5"
Length of Hull	10.49 m	34' - 6"
Length at Waterline	9.17 m	30' - 2"
Beam	3.65 m	12'
Mast Height Above Waterline	16.54 m	54' - 5"
Draft	Fin Keel 2.2 m	6' - 8"
	Wing Keel 1.37 m	4' - 6"
Ballast	Fin Keel 2,355 kg	5,200 lbs
	Wing Keel 2,808 kg	6,200 lbs
Designed Weight	Fin Keel 6,251 kg	13,800 lbs
	Wing Keel 6,704 kg	14,800 lbs
Engine	Yanmar 3YM30 Diesel	21.66 kw 29 hp
Total Water Capacity	404 ltr	101 gal
Holding Tank Capacity	102 ltr	27 gal
Fuel Tank Capacity	113 ltr	30 gal
Sail Area	100% Foretriangle 53 m ²	572 sq. ft.
	Standard 135% Genoa 62 m ²	669 sq. ft.



All specifications are approximate and subject to change without notice.
Actual equipment also subject to change without notice.